

Updating your profile using TERMINALFOUR site manager T4

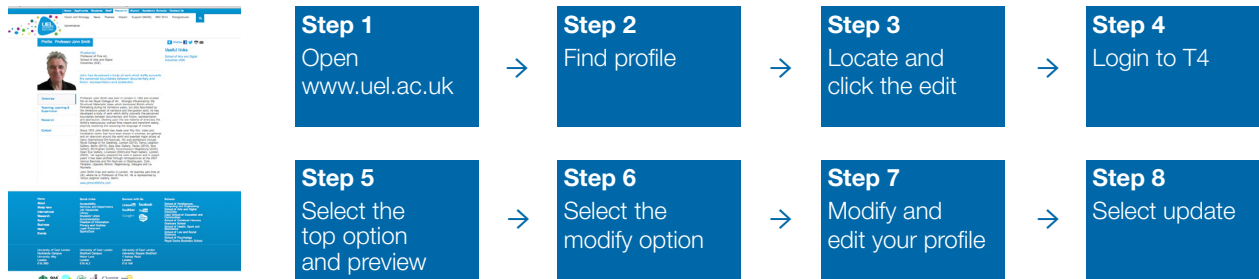

Please follow this series of 8 steps to update your profile



Step 1

Open page **www.uel.ac.uk**.

Step 2

Find **your** profile.

Step 3

Scroll to the **bottom** of the page and click the **'Edit link'** located below 'Copyright © University of East London'.

Step 4

Login to **T4** using your username and password. Select **advanced** and then **auto detect**.

Updating your profile using TERMINALFOUR site manager T4



Step 5

Select the top option 'UEL Website 2013 - Live' and **preview**.

Select A Channel To Preview

The section you have specified can be previewed in the following channels.:

Name	Description	Preview
UEL Website 2013 - Live	Responsive Website 2013 - Publish to Live	Preview
UEL Website 2013 - Staging	Responsive Site Channel - Staging	Preview

[Preview](#)

Step 6

Select the **modify** option which will reveal itself under your **profiles** name.

Home Applicants Students Staff Research Alumni Academic Schools Contact Us

Vision and Strategy News Themes Impact Support (ReDS) REF 2014

Profile Mr Alan Chandler

Modify Delete History

Position(s):

Senior Lecturer and Programme leader, School of Architecture, Computing and Engineering (ACE)

Alan's areas of expertise covers material technology, the theory of architectural conservation design, and community en

- [Overview](#)

Step 7

Modify and **edit** your profile.

Telephone

Breakout text

Overview

Teaching-Supervision

Alan's areas of expertise covers material technology, the theory of architectural conservation design, and community engagement.

Alan Chandler's research record within AVA Architecture was one of the most comprehensive contributions to the recent RAE exercise.

His main published output, as part of an ongoing research programme developed in collaboration with Professor Remo Pedreschi at Edinburgh University, received an RIBA special commendation for University based Research at the 2008 President's Medals ceremony. Seven tonnes of fabric formwork

Path: p

Programmes

Sustainability and Design

Professional Diploma in Architecture (Part II) Supporting Studies

Path: h4 - strong

Step 8

Once complete, select **update**.

Format

Docklands Campus

020 8223 3260

uel.ac.uk

[Save as Draft](#) [Update](#) [Cancel](#)